

AUCTION

09 FEBRUARY 2019

WWW.VALLEYVIEWCOWRA.COM



VALLEY ESTATE VIEW

LOT 11

PREMIUM VACANT REAL ESTATE
GENEROUS 831m² BLOCK
SUITABLE FOR ALL BUILDS
FULLY SERVICED
NBN - FIBRE TO THE PREMISES
EXCLUSIVE LOCATION
ELEVATED POSITION
WIDE STREET FRONTAGE
VIEWS OF LACHLAN VALLEY
WALK TO PEACE PRECINCT

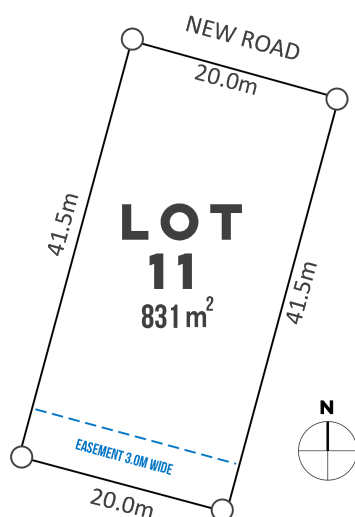
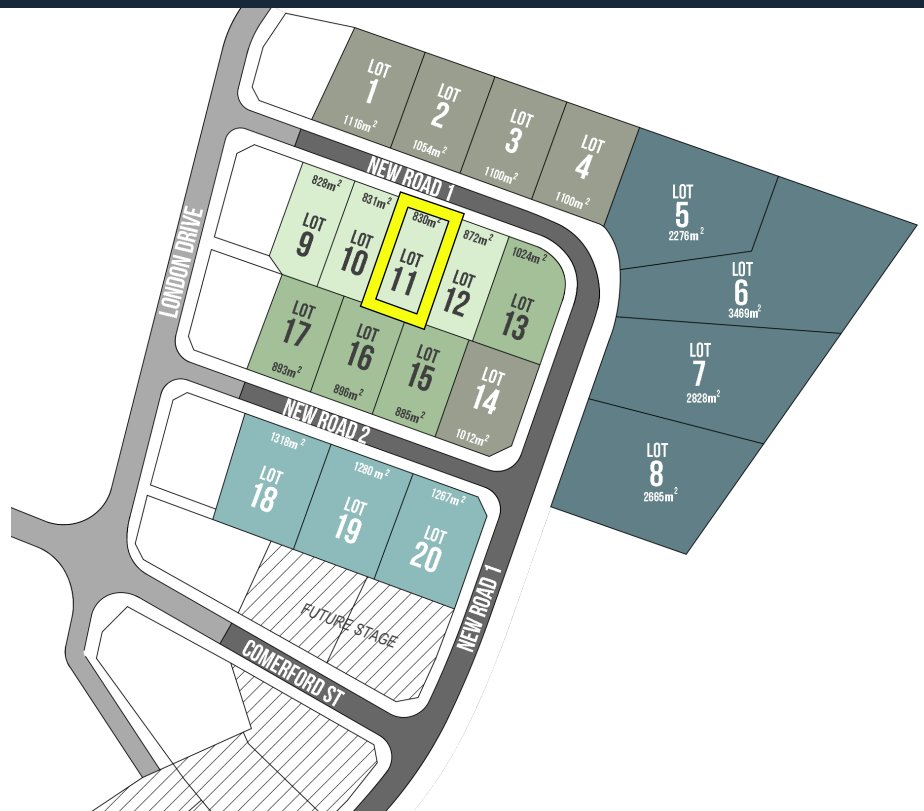

VALLEY VIEW ESTATE - THE PRESTIGE

Located in exclusive North Cowra, Valley View Estate offers future residents everything the name suggests - unobstructed views across the Lachlan Valley.

Valley View Estate delivers the best that Cowra has to offer. The development provides fully serviced and constraint-free lots, wide street verges and lot frontages, quality landscape finishes, all within arm's reach of the historically and culturally significant Cowra Peace Precinct - a magnificent area of passive open space interwoven with walking and riding paths.

Buyer demand for property of this calibre will be at a premium. There are simply no other building blocks like these in the current market. Don't miss your chance to secure a lot in a spectacular location that is destined to become the jewel in Cowra's crown.

GET IN TOUCH

valleyview@cowra.nsw.gov.au
www.valleyviewcowra.com

Telephone 026340 2000
Mobile 0425219809

facebook.com/cowracouncil
twitter.com/cowracouncil

Cowra Shire Council
116 Kendal Street, Cowra